

## How to use the manual override.

Move gate open and closed by hand.

**NB!** The gearbox can be left in manual mode with the manual override hatch closed and locked up.

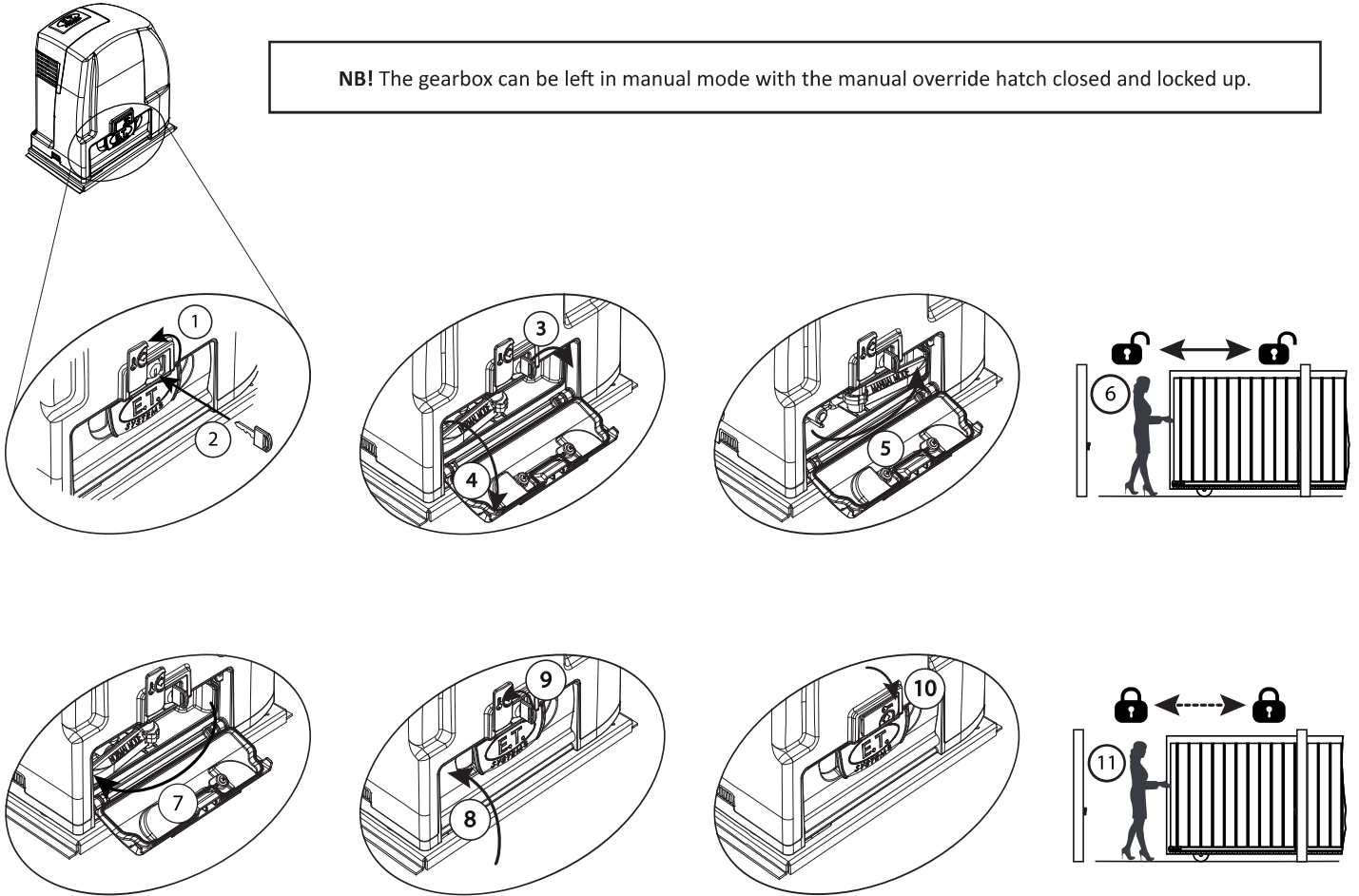

### To disengage the gearbox (Manual mode)

1. Raise lock cover.
2. Insert the key.
3. Turn the key clockwise.
4. Open the manual override hatch.
5. Swing manual override lever to the right.
6. Manoeuvre the gate by hand.

### To re-engage the gearbox (Normal mode)

7. Swing the manual override lever to the left.
8. Close the manual override hatch.
9. Turn the key counter clockwise.
10. Lower the lock cover.
11. Ensure the gearing is engage by pushing or pulling the gate until the gearing "clicks" in.